

## UMX series TPS transmitter for VGA, DVI-I, HDMI and DisplayPort

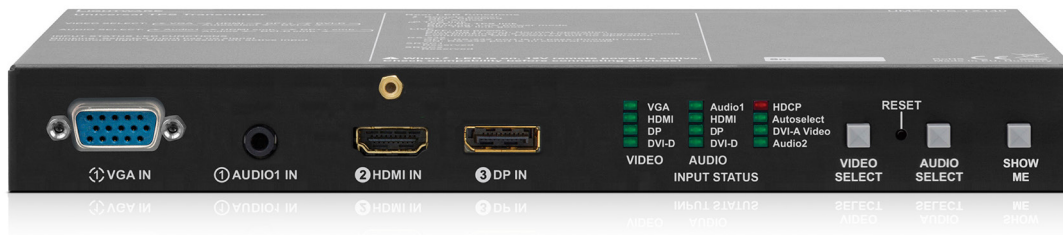

Part No: 9154 0008

### Highlight features

- 3D and 4K support
- Extends DVI, HDMI, VGA or DisplayPort + Ethernet + RS-232 + IR over a single CAT5e...CAT7e cable up to 170 m distance\*
- Audio and video connectors: DVI-I, HDMI, VGA, DisplayPort, Stereo jack, PHOENIX 1x5 pole
- 10/100 Ethernet transmission
- Bi-directional RS-232 and IR
- GPIO control port
- HDCP compliant, CEC, EDID transparent
- Local audio embedding

Lightware's new UMX-TPS-TX140 transmits universal video at a resolution up to 4K, audio and control up to 170 m distance\* over a single CAT cable. This transmitter was designed for digital and analog video and audio signals e.g. DVI, VGA, YPrPb, HDMI1.4 and DP 1.1 with analog stereo audio from local inputs or embedded 7.1 HBR audio and to handle HDCP encryption. Analog signals (both audio and video) are converted to a digital format and can be transmitted separately from each other. Using the factory, custom or transparent EDID emulation the user can fix and lock EDID data on each input connector. Advanced EDID Management forces the required resolution from any video source and fixes the output format conforming to the system requirements. The unit offers bi-directional and transparent IR, RS-232 and Ethernet transmission. Furthermore the IR and RS-232 connection supports command injection, allowing it to send any IR or RS-232 control command directly from the LAN connection.

Remote powering is available through the single CAT cable, but local power supply can also be used. The device can be mounted on a rack shelf or used standalone. Due to Lightware's attentive design the UMX-TPS-TX140 is compatible with both the HDBaseT™\*\* extenders and matrix boards.

\*Depends on cable category and quality

\*\*For further details check the User Manual

### Port diagram

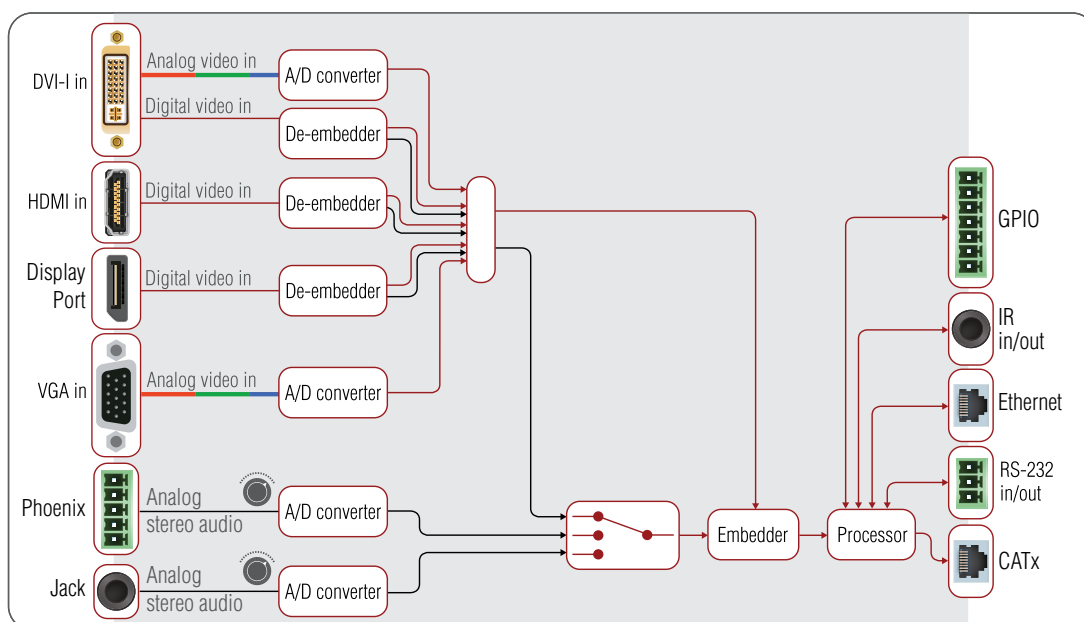

HDBaseT™ and the HDBaseT Alliance logo are trademarks of the HDBaseT Alliance

[www.ivojo.co.uk](http://www.ivojo.co.uk)

## Applications

- Small classrooms
- Conference rooms, meeting rooms
- Control room
- Home cinema

## Features

- 3D and 4K support
- Extends DVI, HDMI, VGA or DisplayPort + Ethernet + RS-232 + IR over a single CAT5e...CAT7e cable up to 170 m distance\*
- Audio and video connectors: DVI-I, HDMI, VGA, DisplayPort, Stereo jack, PHOENIX 1x5 pole
- Embedded 7.1 HBR audio support
- Separate audio and video transmission
- Autoselect mode: video and audio priority modes
- Intuitive Control Software
- 10/100 Ethernet transmission
- Bi-directional RS-232 and IR
- GPIO control port
- HDCP compliant, CEC, EDID transparent
- Local audio embedding
- HDBaseT compatibility
- Advanced EDID management
- No signal latency
- Frame detector
- Remote powering through CAT cable

## Compatible products

- MX Modular matrix frames with MX-TPS-IB
- HDMI-TPS-RX90
- MODEX TPS family
- DVI-HDCP-TPS-RX95
- HDMI-TPS-RX95

## Locking DC plug

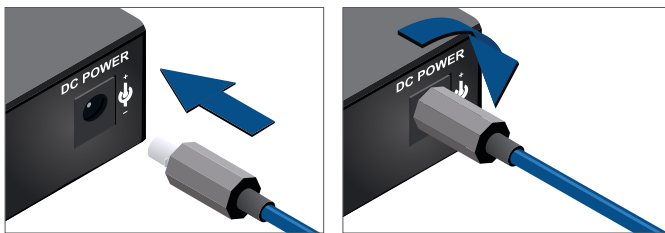

Twist 90° clockwise to lock

Transmitter front and back view

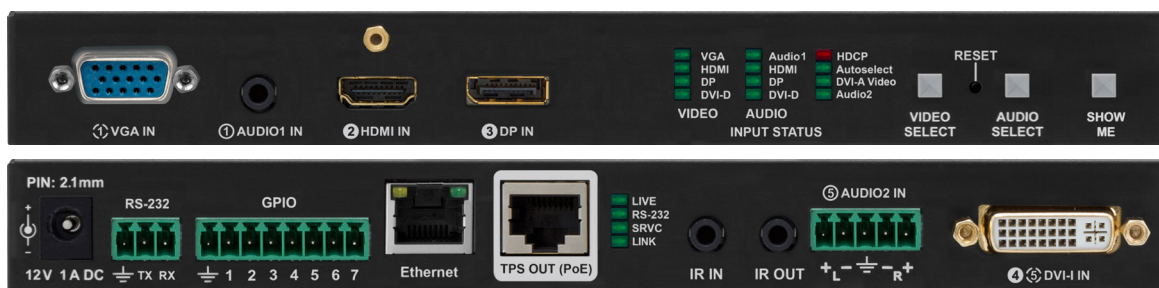

UMX-TPS-TX140

## Specification

Resolution:	Up to 4K UHD 3840x2160@30Hz, 1600x1200@60Hz, FullHD 1920x1080@60Hz
Digital audio formats:	Supports up to 8 channel PCM, Dolby TrueHD and DTS-HD Master Audio 7.1 formats
Input cable equalization:	Automatic max 20 m
EDID emulation:	Yes, Advanced EDID Management
EDID memory:	120 factory preset, 15 user programmable
VGA to digital conversion:	0 microseconds delay
HDCP pass-through:	Yes
RS-232 pass-through:	Yes, configurable
RS-232 (control option):	9600, 19200, 38400, 57600, 115200 Baud Rx,Tx (local or through CATx)(default: 57600)
Local power:	Universal power adaptor, DC 12V 2.5A
Power over TPS:	DC 48V 1 A
Enclosure:	1 mm metal
Dimensions:	221 W x 100.4 D x 26 H mm
Compliance:	CE
Warranty:	3 years

## Connectors

Digital video input:	HDMI connector, DVI-I connector, DisplayPort
Analog video input:	VGA connector
Audio input:	Stereo jack, 5-pole Phoenix
Ethernet:	1 x RJ45
TPS output:	1 x RJ45
Control:	7 x GPIO, IR
Serial port:	3-pole
Power:	Locking DC connector (2.1 / 5.5 mm)

## Analog audio input

Volume:	-96 .. 0 dB
Balance:	0 .. 100%

## Supplied accessories



### PSU-12VU Universal DC adaptor (Part No: 1180 0051)

Wall power adaptor with interchangeable plug for international use.  
Universal input: 100-240 V AC, 50-60 Hz, output: 12 V DC, 2.5 A



### IR emitter and IR eye (Part No: 1374 0003 TX, 1374 0002 RX)

IR emitter is supplied with TPS-TX, IR eye is supplied with TPS-RX units. Needed for IR extension.

## Optional accessories



### Under desk mounting kit double (Part No: 5240 0276)

The UD-kit double makes it easy to mount multiple devices on any flat surface (e.g. furniture).



### Rack shelf (Part No: 5240 0269)

1U high rack shelf provides mounting holes for fastening four quarter-rack sized units. Pocket sized devices can also be fastened on the shelf.