AMS READY

The Atlona AT-HDVS-150-RX is an HDBaseT™ scaler receiver for HDMI transmission over category cable. It receives AV signals up to 1080p/60Hz and 1920×1200 video with embedded multi-channel audio and control signals up to 230 feet (70 meters). Features include balanced analog audio de-embedding, RS-232 control, and Power over Ethernet for compatible transmitting devices. The receiver offers advanced scaling capabilities including image adjustment capability and an Auto-set feature for matching incoming signals to the display's native resolution. Designed for use with the AT-HDVS-150-TX transmitter, the transmitter/receiver pair enables auto display on/off, auto-switching, third-party control, and other features. The built-in scaler works with matrix switchers to optimize source signals with different resolutions to a display's native resolution. The AT-HDVS-RX is ideal for long distance transmission and display control in corporate or educational settings using analog and digital sources.

The HDVS-150 maintains all capabilities the HDVS series is known for and adds industry-standard Power over Ethernet for full HDBaseT certification. The HDVS-150 Series is a simple audio visual system with auto-switching for HDMI and VGA inputs, projector on/off control, analog audio de-embedding, volume control, and a scaler. Much more than an extender system, it provides a complete system for small spaces like huddle rooms and teaching spaces with 2 or 3 sources.

Long distance HDMI extension -

- Receives HDMI and VGA/Audio signals up to 230 ft (70m) @ 1080p over CAT6a/7 and 197 feet (60 m) @1080p over CAT5e/6
- Uses easy-to-integrate category cable for low-cost, reliable system installation

Scaled HDMI output and input resolution control -

- Scales output video signals up to 1080p/60Hz and 1920x1200; Set preferred input resolution from 800x600 to 1920x1200
- Assures compatibility of VGA and HDMI sources to the display's native resolution

RS-232 scaler control -

- Image adjustments, resolution settings, and auto-set to display's native resolution can be made from a third party control system
- Seamless integration with larger, control system-based AV systems

Power over Ethernet for AT-HDVS-150-TX -

- Industry standard IEEE 802.3af PoE supplied by the receiver over HDBaseT
- No local AC outlet required at the AT-HDVS-150-TX switcher; saves time and integration costs

Audio de-embedding -

- Provides two channel, analog audio signal on balanced captive screw connectors
- Improves AV system audio with the use of an external amplifier such as the Atlona AT-PA100-G2

RS-232 display control -

- Facilitates On/Off display control; Included software simplifies programming
- Eliminates need for complex control system in small AV systems

Field updatable firmware -

- Rear panel USB port provides an easy means for kit upgrades
- Ensures long term system return on investment

Specifications

Video Resolutions

| | |
|-------------|--|
| IN | 1080p@23/24/25/29/30/50/59/60Hz, 1080i@50/59/60Hz, 720p@25/29/30/50/59/60Hz, 576p, 576i, 480p, 480i |
| | 1920x1200RB, 1680x1050, 1600x1200, 1600x900, 1440x900, 1400x1050, 1366x768, 1280x1024, 1280x960, 1280x800, 1280x768, 1152x864, 1024x768, 800x600, 720x400, 640x480 |
| OUT | 1080p@24/25/29/30/50/59/60Hz, 1080i@50/59/60Hz, 720p@30/50/59/60Hz |
| Color Space | 1920x1200, 1680x1050, 1600x1200, 1400x1050, 1366x768, 1280x1024, 1280x800, 1024x768 |
| Color Depth | RGB, YCbCr 444, YCbCr 422 |
| | 10-bit, 12-bit, 16-bit |

Audio

| | |
|-------------|--|
| Formats | PCM 2Ch, LPCM 5.1, LPCM 7.1, Dolby Digital, DTS 5.1, Dolby Digital Plus, Dolby TrueHD, DTS-HD Master Audio |
| Sample Rate | 44.1kHz, 48kHz, 96kHz, 192kHz |

Distance

| | | |
|---------|-----------|----------|
| HDMI | 10 meters | 30 feet |
| CAT5e/6 | 60 meters | 197 feet |
| CAT6a/7 | 70 meters | 230 feet |

Signal

| | |
|-----------|-----------|
| Bandwidth | 6.75 Gbps |
| CEC | No |
| HDCP | Compliant |

Temperature

| | | |
|-----------|--------------------------|---------------|
| Operating | 0°C to 40°C | 32°F to 104°F |
| Storage | -20°C to 60°C | -4°F to 140°F |
| Humidity | 20 to 90% non-condensing | |

Power

| | |
|-------------|---|
| Consumption | 15W (varies per paired transmitter) |
| Supply | Input: AC 100-240V ~ 50/60Hz Output: DC 24V/2.7A |

Dimension

| | | |
|-----------|---------------------|--------------------------|
| H x W x D | 30 x 122 x 125 (mm) | 1.18 x 4.8 x 4.92 (inch) |
|-----------|---------------------|--------------------------|

Weight

| | | |
|--------|---------|----------|
| Device | 0.31 kg | 0.67 lbs |
|--------|---------|----------|

Certification

| | |
|--------------|--|
| Unit | CE, FCC |
| Power Supply | CE, FCC, Level VI, RoHS, cULus, RCM, CCC |

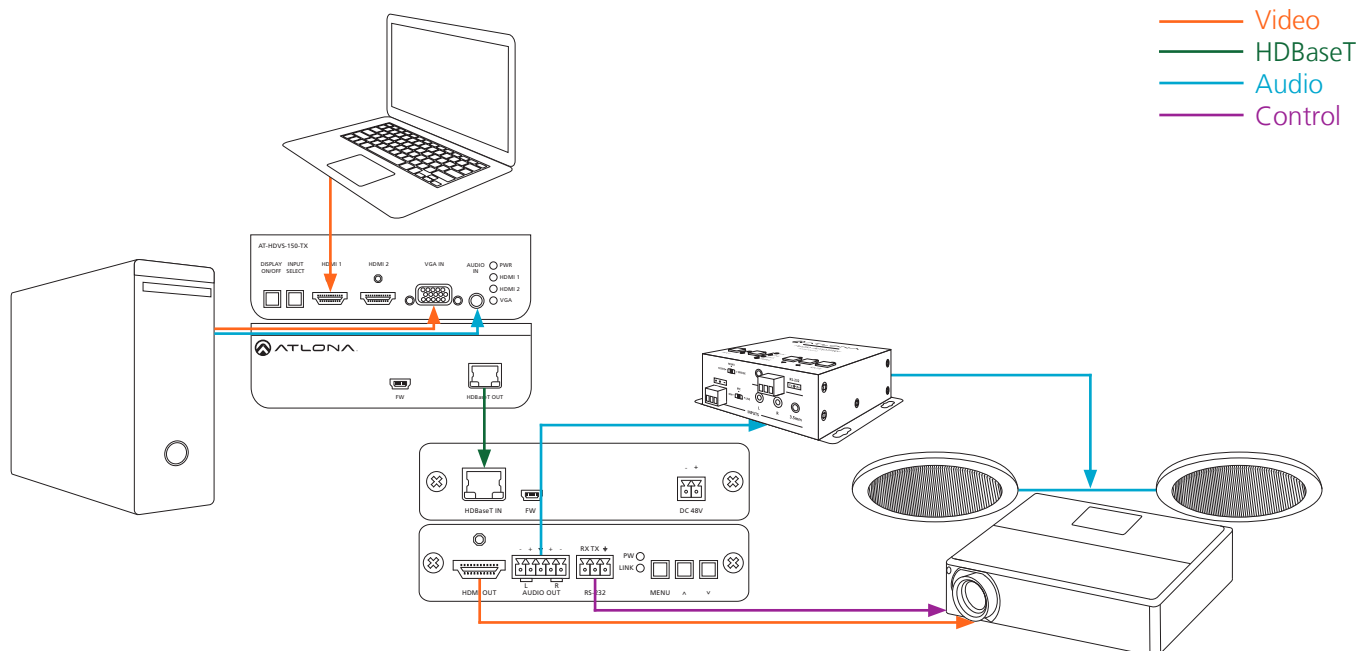

Specifications and availability subject to change without notice. Actual products, product images, and online product images may vary from images shown here. Not responsible for typographical errors.