

2160p 4:4:4/60 In-Line HDMI Scaler with Audio Breakout

CON-H2-SCL

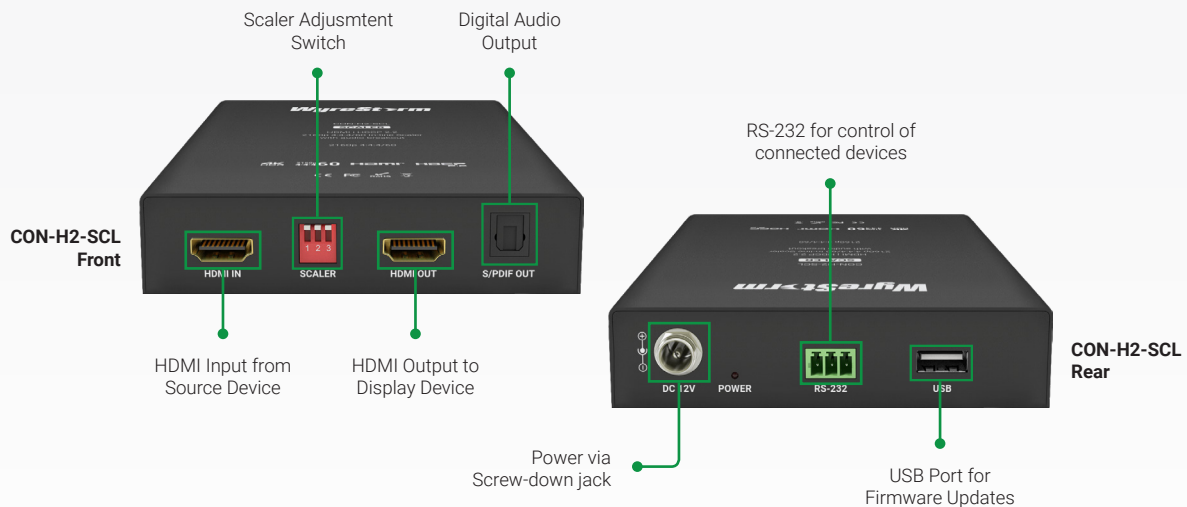

4K UHD 2160p 4:4:4 60 HDMI HDCP 2.2

WyreStorm - Because the Technology Matters.

Introduction

An essential tool when mixing 4K & 2K screens on the same distribution system, the CON-H2-SCL enables in-line scaling of HDMI content. An HDMI signal from a source device, DA or matrix is converted so that it can be accepted by the connected display. Via a powerful scaling chip, 4K/60 4:4:4 or 4:2:0 can be down-scaled to as low as 480P; likewise, content can be up-scaled to 4K/60 4:4:4. Set up & configuration is done using a simple PC tool which is part of WyreStorm Management Suite V1.6. The software tool allows management of the scaling function and EDID via a simple interface.

Key Features

- Scales any incoming HDMI content to as low as 800x600 or up to 4096x2160
- Compatible with incoming 18Gbps HDMI content up to 2160p 4:4:4/60
- Converts HDR content and removes metadata for compatibility with all displays
- Converts HDCP encryption to match that of a connected display or projector
- Optical audio output for de-embedded source audio (2ch PCM)
- Setup & configuration via simple PC configuration tool (WyreStorm Management Suite v1.6 or higher)
- Powered by 12v DC power supply (US, UK, EU and AU PSU pins included)
- Mounting brackets included
- USB-3-pin phoenix cable required for setup (not included) - use p/n CAB-USB-PX1
- Full scaling list: Auto set (based on EDID from display) 4096x2160/60 4096x2160/30 4096x2160/25 4096x2160/24 3840x2160/60 3840x2160/50 3840x2160/30 3840x2160/25 3840x2160/24 1920x1200/60 1920x1080/60 1920x1080/50 1280x720/60 1280x720/50 1680x1050/60 1600x1200/60 1600x900/60 1440x900/60 1366x768/60 1360x768/60 1280x1024/60 1280x960/60 1280x800/60 1280x768/60 1024x768/60 800x600/60

In the Box

1x CON-H2-SCL
1x DC 12V 2A Power Supply (US/UK/EU/AU)
3x 3-Pin Terminal Block

2x Mounting Brackets
1x Quickstart Guide

Specifications

Audio and Video		
Inputs	1x HDMI In: 19-pin type A	
Outputs	1x HDMI Out: 19-pin type A 1x S/PDIF Out: TOSLINK (Digital Optical)	
Audio Formats	HDMI Pass-through: 2ch PCM S/PDIF Out: De-Embed: 2ch PCM	
Video Resolutions (Max)	Video Resolution	HDMI
	1920x1080p @60Hz 12bit	15m/49ft
	3840x2160p @24Hz 10bit 4:2:0 HDR	7m/23ft
	3840x2160p @30Hz 8bit 4:4:4	7m/23ft
	3840x2160p @60Hz 10bit 4:2:0 HDR	5m/16ft
	3840x2160p @60Hz 12bit 4:2:2 HDR	3m/10ft
	4096x2160p @60Hz 8bit 4:2:0	7m/23ft
	4096x2160p @60Hz 8bit 4:4:4	3m/10ft
Supported Standards	DCI RGB HDR HDR10 Dolby Vision HLG BT.2020 BT.2100	
Maximum Pixel Clock	600MHz	
Communication and Control		
HDMI	HDMI 2.0 HDCP 2.2 EDID Inputs supports DVI/D and DisplayPort Dual-Mode (DP++) v1.3 with adapter (not included)	
RS-232	1x RS-232: 3-pin Terminal Block - 3.5mm	
USB	1x USB: USB-A Firmware Updates Only	
Power		
Power Supply	12V DC 2A	
Max Power Consumption	8.38W	
Environmental		
Operating Temperature	32°F ~ 113°F (0°C ~ 45°C) 10% ~ 90%, non-condensing	
Storage Temperature	-4°F to ~ 158°F (-20°C ~ +70°C) 10% ~ 90%, non-condensing	
Maximum BTU	29 BTU/hr	
Dimensions and Weight		
Rack Units Wall Box	<1U	
Height With Without Feet	25mm/0.99in	
Width With Without Brackets	110mm/4.34in	
Depth With Without Handles	150.1mm/5.91in	
Weight	0.476kg/1.05lbs	
Regulatory		
Safety and Emission	CE FCC RoHS RCM	

Right Product for the Right Application.

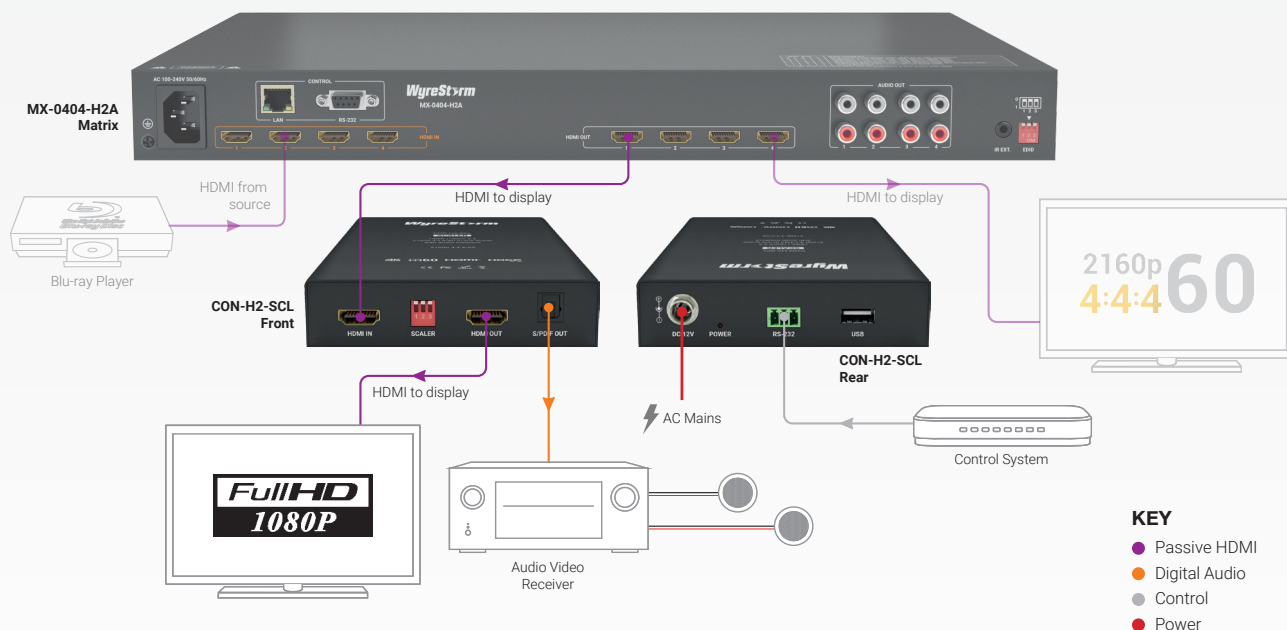

Note: WyreStorm reserves the right to change product specification, appearance or dimensions of this product at any time without prior notice.