



euroscreen® Linea Tab Tension

SCREEN SURFACES



FlexWhite

Pliable matt white front surface, superb colour rendition, Full HD compliant. Gain 1.0.



ReAct 2.1

Pliable silver grey front surface, enhances colour contrast in bright light, Full HD compliant. Gain 1.0.



FlexPerf

White material with microscopic perforations which create a sound transparent projection surface. Gain 0.8.



FlexRear

Neutral grey rear projection surface. Only available without borders. Gain 2.5.

PROJECTION FORMATS

4:3

The screen has 5 cm wide black borders. The format of the viewing area is 4:3.

16:10

The screen has 5 cm wide black borders. The format of the viewing area is 16:10.

16:9

The screen has 5 cm wide black borders. The format of the viewing area is 16:9.

2.35:1

The screen has 5 cm wide black borders. The format of the viewing area is 2.35:1.

CONTROL OPTIONS



Accessories

Euroscreen® Control Box is included to add additional controls for convenience.

The basic add-ons are:

- RF remote control
- IR transmitter
- RF AutoLink
- 12V trigger cable

For full description of options please see separate spec sheet.

The Linea Tab Tension cassette has a unique designed shape which consists of gently rounded aluminium, with no exposed mounting fixtures or fasteners, and all attachment points are completely invisible. The case is finished in white and the white heavy weight bottom dowel retracts completely inside the case when the screen is not in use. Thanks to the tensioning wires, which are integrated along the screen surfaces vertical edges, a fully flat screen surface can be obtained for many years in use. A perfectly flat screen surface is a requirement when using Short Throw projectors where the wide angled projector lens put higher demands on the quality of the projection screen.

Delivered with 30cm as standard. "No borders" are standard on all rear projection screens and available on request for the other surfaces. Screen delivered for wall mount, prepared for ceiling mount. Ceiling mount requires rewiring. Motor to the left as standard. Quiet motor available upon request. Please note: The surfaces are sensitive to heat and are not suitable as black-out, or sun protection. Do not install close to heat sources like radiators, amplifiers or turned on TV-sets.

SCREEN DIMENSIONS

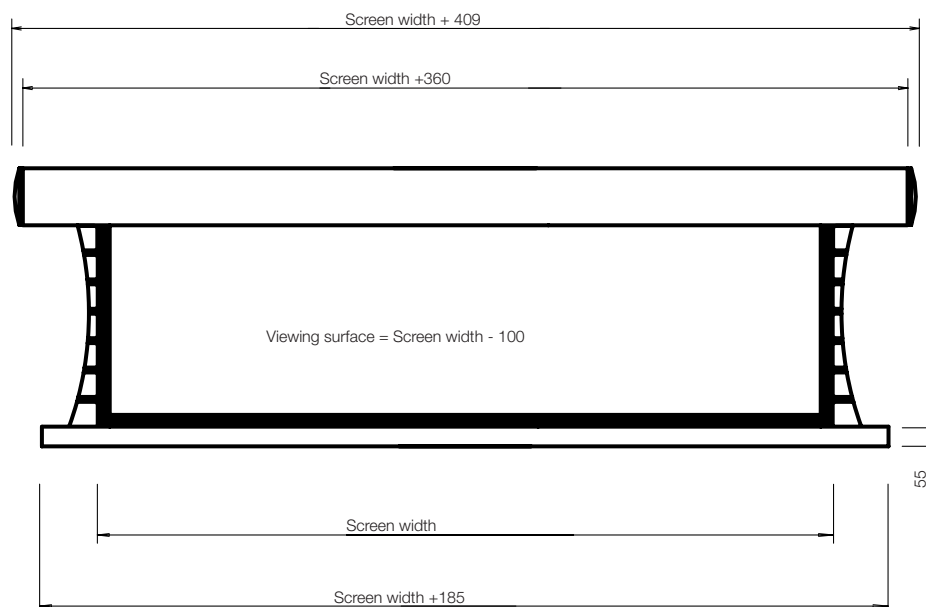

CASE DIMENSIONS

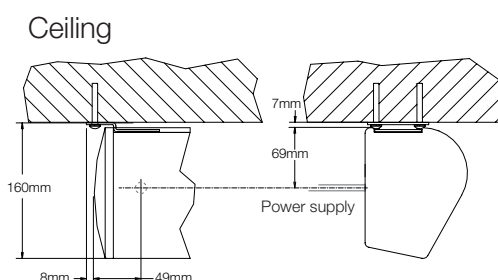

Wall

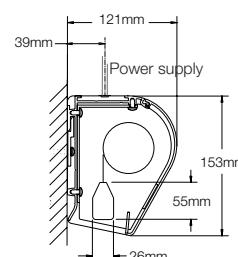

BRACKET DIMENSIONS

Brackets – Wall

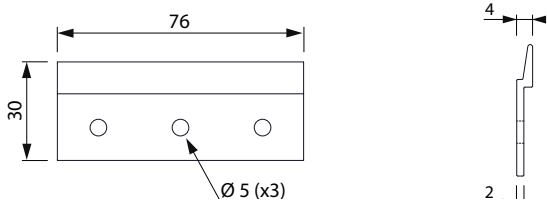

Brackets – Ceiling

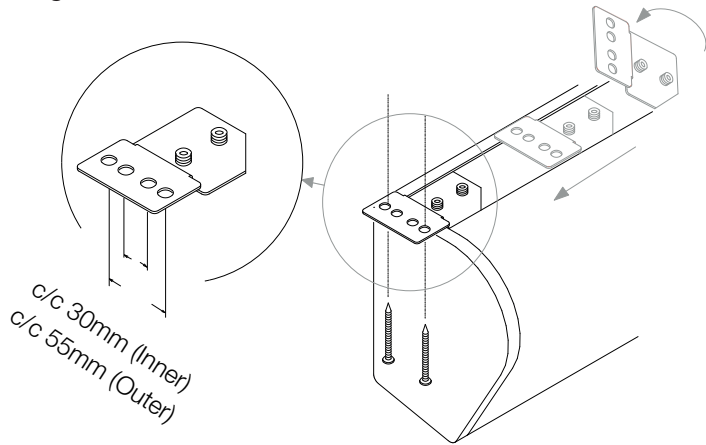

PACKAGING DIMENSIONS

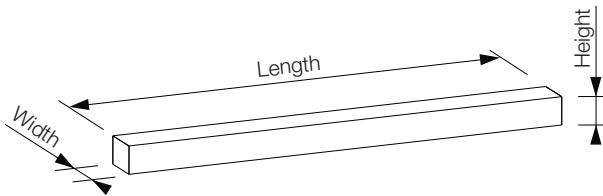

Screen width	Box length	Box width	Box height
1600	2260	260	260
1800	2460	260	260
2000	2660	260	260
2200	2860	260	260
2400	3060	260	260
2700	3360	260	260
3000	3660	260	260