

PRODUCT DIMENSIONS AND SPECIFICATIONS

SPECIFICATIONS			
Projection system (3LCD)	Epson EB-84 - Epson EB-85	Epson EB-825	Epson EB-826W
Native resolution	0.63" (x3) Polysilicon	0.63" (x3) Polysilicon	0.59" with MLA (x3) Polysilicon
Native aspect ratio	TFT active matrix	TFT active matrix	TFT active matrix
Resolution supported	XGA (1024 x 768)	XGA (1024 x 768)	WXGA (1280 x 800)
White Light Output (brightness) **	4:3	4:3	16:10
Colour Light Output	VGA ~ UXGA	VGA ~ UXGA	VGA ~ UXGA
	2600 lm / 2080 lm (Normal / Eco)	3000 lm / 2400 lm (Normal / Eco)	2500 lm / 2000 lm (Normal / Eco)
	2600 lm / 2080 lm (Normal / Eco)	3000 lm / 2400 lm (Normal / Eco)	2500 lm / 2000 lm (Normal / Eco)
PROJECTION LENS			
Throw ratio	1.38 - 2.24 : 1	1.38 - 2.24 : 1	1.38 - 2.24 : 1
Focal Length / F Number	18.2 mm - 29.2 mm / 1.49 - 1.94	18.2 mm - 29.2 mm / 1.49 - 1.94	18.2 mm - 29.2 mm / 1.49 - 1.94
Focus / Zoom type	Manual focus / 1.6 x Optical Zoom	Manual focus / 1.6 x Optical Zoom	Manual focus / 1.6 x Optical Zoom
Offset	8.6:1	8.6:1	10:01
LENS PROTECTION	A/V mute slide		
LAMP			
Type	E-TORL 200W UHE		
Life (Eco / Normal mode)	6000 hours / 5000 hours		
IMAGE			
Colour Reproduction	Full-Colour (16.77 million colours)		
Fan noise (Eco / Normal mode)	28 dB / 35 dB		
Contrast ratio **	2000:1		
Screen size (Projection distance)	30" to 300" (0.83 m - 8.54 m)		
Keystone correction	Vertical (automatic); ± 30 degrees		
INPUT			
Computer	2 x D-sub 15-pin (RGB)		
Video	1 x D-sub 15-pin (component), 1 x RCA, 1 x S-Video		
Audio	2 x Stereo mini-jack in, 1 x Stereo mini-jack Microphone, 1 x Stereo RCA		
USB	1 x USB 2.0 type A *, 1 x USB 2.0 type B		
Control	1 x RS232C (D-Sub 9pin)		
Network	LAN via RJ45		
OUTPUT	1 x D-sub 15-pin, 1 x Stereo mini-jack out		
BUILT-IN SPEAKER	10 W monaural		
DIRECT POWER ON / OFF	Yes		
SECURITY	Improved security bar, kensington lock hole, password protection, control panel lock		
OTHER FUNCTIONS	Auto source search, quick start (8 sec.), 9 colour modes, microphone input, monitoring over network, SNMP, user logo, freeze, E-Zoom, help, test pattern, user button on remote control, improved dust resistant design		
OPERATING TEMPERATURE / ALTITUDE	5°C to 35°C / 0 to 2,286 m (High Altitude Mode over 1500 m)		
POWER REQUIREMENTS			
Power supply wattage	100 - 240 V AC ±10%, 50/60 Hz		
Power consumption lamp on	228W (Eco) / 275W		
Power consumption stand-by	3W (communication off) / 8.9W (communication on)		
WEIGHT AND DIMENSIONS			
Weight	3.1 kg		
Dimensions (D x W x H)	250 x 327 x 95 mm (excluding feet)		
ON-SCREEN MENU	34 languages: English / French / German / Italian / Spanish / Catalan / Portuguese / Dutch / Danish / Polish / Hungarian / Czech / Romanian / Slovenian / Norwegian / Swedish / Finnish / Russian / Ukrainian / Greek / Turkish / Arabic / Croatian / Slovak / Bulgarian / Malay / Vietnamese / Hebrew / Japanese / simplified Chinese / traditional Chinese / Korean / Thai / Indonesian		
SUPPLIED ACCESSORIES			
Power Cable	3 m		
Computer Cable	1.8 m D-sub 15pin (Male / Male)		
USB Cable	1.8 m USB-A to USB-B		
Soft carry case	included		
Remote Control	included with 2 x AA type batteries		
Epson Projector Software (CD-ROM)	included		
Password Protect Sticker	included		
User Manual	included		
OPTIONAL ACCESSORIES			
Wireless LAN unit (a/b/g)	ELPAP03 *		
Quick Wifi Connection USB key	ELPAP04 *		
Visualiser	ELPDC05 *		
Lamp	ELPLP50		
Filter	ELPAF22		
Ceiling Mount	ELPMB23		
WARRANTY	3 years main unit - 1 year on lamp		

* Excludes EB-84 ** ISO 21118 based measurement



Better Products
for a Better Future™

For further information please contact your local Epson office or visit www.epson-europe.com

Austria 0810/20 01 13 (0,07 €/Min.) **Belgium** 070/350120 (0.1735 €/min.) **Czech** 800/142 052 **Denmark** 44 50 85 85
Finland 0201 552 091 **France** 09 74 75 04 04 (0,12 €/min) **Germany** 01805/23 41 10 (0,14 €/Min.) **Greece** 210-8099499
Hungary 06800 147 83 **Ireland** 01 436 7742 **Italy** 02-660321 10 (0,12 €/min.) **Luxemburg** 900/43010 (0,24 €/min.)
Middle East +9714 8818934 **Netherlands** 0900-5050808 (0.05 €/oproep + 0.15 €/min.) **Norway** 22 06 42 80
Poland 0-0-800 4911299 (0,16 zł/min.) **Portugal** 707 222 111 **Russia** (095) 777-03-55 **Slovakia** 0850 111 429
South Africa (+2711) 465 9621 **Spain** 93 582 15 00 **Sweden** 0771-400135 (Mobilsamtal – 0,99 kr/min, Lokala samtal – 0,30 kr/min, Utlandssamtal – 0,89 kr/min) **Switzerland** 0848 448820 (4-8 cent./min.) **Turkey** (0212) 3360303
United Kingdom 0871 222 6702

Trademarks and registered trademarks are the property of Seiko Epson® Corporation or their respective owners.
Product information is subject to change without prior notice.

EPSON EB-8 SERIES



Front view

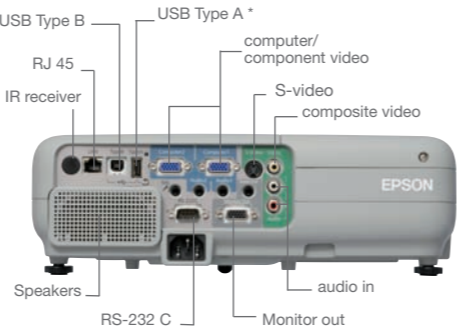

Rear view

Screen size in inch	4:3 aspect ratio			
	Wide		Tele	
cm	inch	cm	inch	
30	83	33	136	54
40	111	44	182	72
50	140	55	229	90
60	169	66	275	108
80	226	89	368	145
100	283	111	460	181
150	426	168	692	272
200	568	224	923	363
250	711	280	1155	455
280	854	336	1386	546

Screen size in inch	16:10 aspect ratio			
	Wide		Tele	
cm	inch	cm	inch	
30	88	35	144	57
40	118	47	193	76
50	149	58	243	95
60	179	70	292	115
80	239	94	390	153
100	300	118	488	192
150	451	178	733	289
200	603	237	979	385
250	754	297	1224	482
280	845	333	1371	540



EPSON EB-8 SERIES

PRESENT SMARTLY



EPSON EB-8 SERIES

These four lightweight projectors have everything you need to give a successful presentation. Providing great images and innovative features, they are easy to use and highly energy-efficient.

Wide connectivity and new features

The Epson EB-8 Series (84, 85, 825, 826W) provides many features to improve the quality of your projection experience. These include microphone input and powerful integrated speakers for easier speaking in a large room; USB Direct connection, which allows you to plug in the new Epson Visualiser and project a source document or 3D objects directly, as well as normal projection from a PC onto a larger screen. And so that you can focus on your audience and your presentation, all of these features are accessible from the new remote control.

Exploit your network

You can remotely configure and operate the projector over your network with ease, thanks to Epson EMP Monitor™ software. For example, you can set an e-mail alert for the internal temperature of your projector or to monitor lamp status, and have advanced notice of any problems that could disrupt your presentation.

Thanks to their wide connectivity, mobility and easy, convenient features the EB-8 Series are perfect for use in educational environments.

Our contribution to the environment

The Epson EB-8 Series is designed and produced in compliance with our environmental policy. Energy efficiency is achieved with of a long lamp-life. Add in easy maintenance and the result is a low total cost of ownership, which makes these projectors particularly attractive.

Environmentally friendly and cost-effective

- Minimises power consumption when not in use (timer functions, rapid power on/off)
- Reduces pollution: no paint used in manufacture, 100% recyclable packaging
- Provides clear visibility in light rooms and saves money thanks to the E-TORL Lamp - up to 6,000 hours lifetime in Eco mode

We are committed to providing the highest performance in our projectors by integrating innovative technologies.



Source: Futuresource Consulting Ltd.



3LCD technology provides superb image quality with smooth and natural colour reproduction.

Colour Light Output, the new metric for projector brightness

Epson provides Colour Light Output specification data. Colour Light Output measures a projector's ability to deliver colour. Colour Light Output provides users with a simple, accurate and easy to understand way to evaluate projector colour performance.

COMPACT, YET FULL OF SMART, CONVENIENT FEATURES

Jpeg viewer: go light, leave your PC behind. Simply plug in your USB key and start your presentations

Quick start, quick cool down: warms up in 8 seconds, cools down instantly

Quick and easy wireless connection*: plug the optional wireless module into your projector, and display your PC desktop within seconds
* Excludes EB-84

Great sound: amplify your voice in large or noisy rooms by using a microphone and the powerful 10W integrated speakers

A/V mute slide: instantly cuts both projector and sound, enabling the audience to focus entirely on your presentation

Totally secure: it can be ceiling-mounted and secured by a reinforced bar and Kensington lock

Simple and flexible installation: get perfect image on screen with the automatic keystone ($\pm 30\%$ vertically) and the new x1.6 optical zoom

CUTTING-EDGE CONNECTIONS: USB CABLE

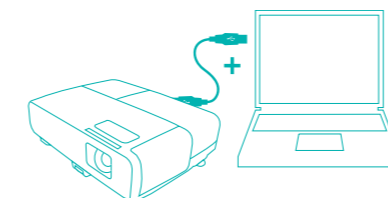

The easiest way to project from a PC: 2-in-1 USB display

A single USB cable, connecting the projector to your PC, combines the functions of display and Page Up/Down, halving the number of cables you need.

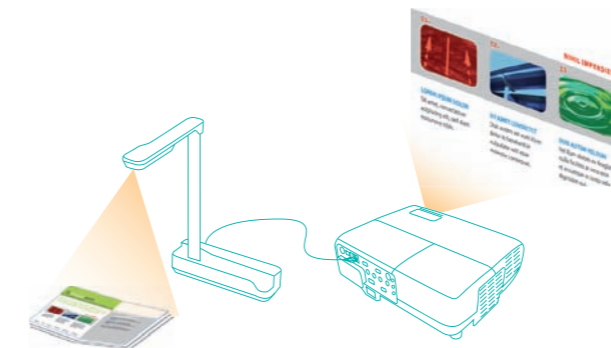

Connection to the Epson Visualiser

Project documents and objects directly just by plugging in the new Epson Visualiser via a USB cable.

CHOOSE THE RIGHT PROJECTOR FOR YOU

EPSON EB-84



EPSON EB-85



EPSON EB-825



EPSON EB-826W

