



# euroscreen® Linea Tab Tension

## SCREEN SURFACES



### FlexWhite

Pliable matt white front surface, superb colour rendition, Full HD compliant. Gain 1.0.



### ReAct II

Pliable silver grey front surface, enhances colour contrast in bright light, Full HD compliant. Peak gain 1.1



### FlexRear

Neutral grey rear projection surface. Only available without borders. Gain 2.5.

## PROJECTION FORMATS

4:3

The screen has 5 cm wide black borders. The format of the viewing area is 4:3.

16:10

The screen has 5 cm wide black borders. The format of the viewing area is 16:10.

16:9

The screen has 5 cm wide black borders. The format of the viewing area is 16:9.

2.35:1

The screen has 5 cm wide black borders. The format of the viewing area is 2.35:1.

## CONTROL OPTIONS



The screen is supplied with the Euroscreen® Control Box. It is recommended to add additional controls for convenience. The basic add-ons are:

- IR transmitter
- RF transmitter
- AutoLink
- 12V trigger cable

For full description of options please see separate spec sheet.

The Linea Tab Tension cassette has a unique designed shape which consists of gently rounded aluminium, with no exposed mounting fixtures or fasteners, and all attachment points are completely invisible. The case is finished in white and the white heavy weight bottom dowel retracts completely inside the case when the screen is not in use. Thanks to the tensioning wires, which are integrated along the screen surfaces vertical edges, a fully flat screen surface can be obtained for many years in use. A perfectly flat screen surface is a requirement when using Short Throw projectors where the wide angled projector lens put higher demands on the quality of the projection screen.

Delivered with multi functional control box and top drop of 30cm as standard. "No borders" are standard on all rear projection screens and available on request for the other surfaces. Screen delivered for wall mount, prepared for ceiling mount. Ceiling mount requires rewiring. Motor to the left as standard. Quiet motor available upon request. Please note: The surfaces is sensitive to heat and is not suitable as black-out, or sunprotection. Do not install close to heat sources like radiators, amplifiers or turned on TV-sets.

## SCREEN DIMENSIONS

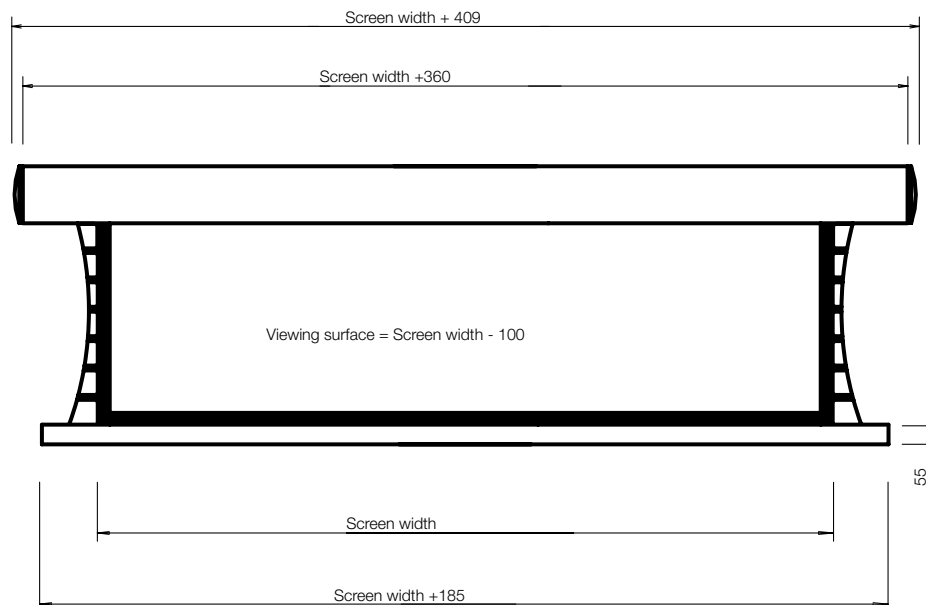

## CASE DIMENSIONS

### Ceiling

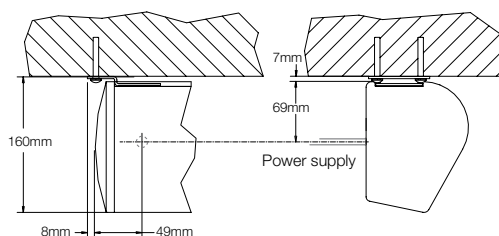

### Wall

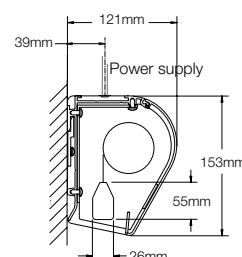

ELECTRICAL SPECIFICATIONS

Euroscreen® Control Box

Communication – Manual / RF / IR / wired

Enclosed with screen. Screen supplied with box only, demands manual operation.

Cable Specifications

Thickness: Ø 7 mm  
Cable area: 4x0,5mm<sup>2</sup> , motor to control  
3x0,75mm<sup>2</sup> , control to plug  
Wires: Black - Up  
Brown - Down  
Blue - Neutral  
Green/Yellow - Ground

Motor Specifications

Voltage: 220 V      Frequency: 50 Hz  
Power: 200 W      Momentum: 30Nm  
Speed: 17 rpm      Protection: IP44

The motor is grounded.

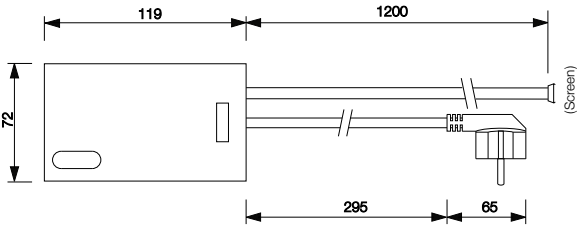

BRACKET DIMENSIONS

Brackets – Wall

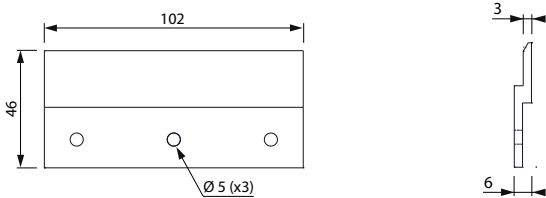

Brackets – Ceiling

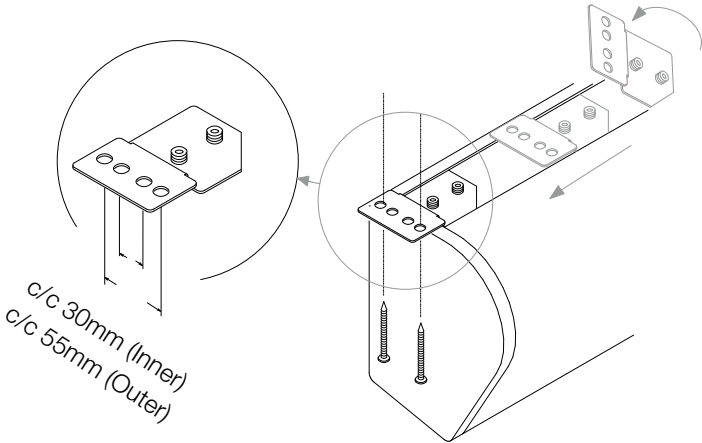

PACKAGING DIMENSIONS

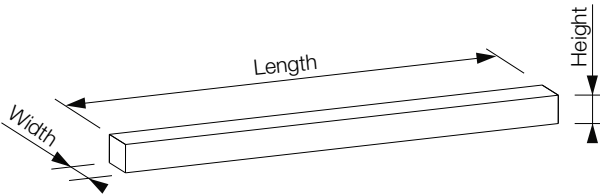

Screen width	Box length	Box width	Box height
1600	2260	260	260
1800	2460	260	260
2000	2660	260	260
2200	2860	260	260
2400	3060	260	260
2700	3360	260	260
3000	3660	260	260