

**XEED** BRIGHTER THINKING

## Projection Solutions

XEED WUX10 Mark II

XEED SX7

XEED SX6

XEED SX80 Mark II

XEED SX800

XEED X700

you can



**Canon**





## Make an Impact.

For professionals who understand the importance of visual impact, a XEED projector is the natural choice. Canon's combination of award-winning optics and LCOS technology delivers outstanding images – and with most models projecting at SXGA+ resolution or higher, presentations can be supercharged with High Definition content.

**XEED WUX10 Mark II | XEED SX7 | XEED SX6 | XEED SX80 Mark II | XEED SX800 | XEED X700**



## Designed for Versatility.

The high resolution and precision optics of the XEED range allow for a broad range of applications – including technical or medical uses where ultra-fine detail is essential. For designers, printers and other graphics professionals, selected models support the Adobe RGB colour space.



## Quiet and Compact.

Thanks to the light path efficiency of AISYS, XEED projectors deliver heavyweight performance from a compact, lightweight form. Complemented by whisper-quiet operation with minimal fan noise, XEED helps keep the audience focused on your presentation.

## The XEED Formula.

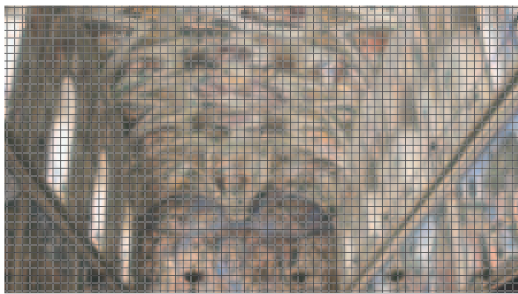

LCD technology



XEED LCOS technology

### THE LCOS ADVANTAGE

To overcome the unsightly 'lattice' and 'rainbow' effects, the XEED range uses superior LCOS panels. These combine the best of LCD and DLP projection technologies, to produce smooth, flawless images with faithful colour reproduction and exceptionally fast response, making them ideal for both still and moving images.



Projection Lens



Dual-sided aspherical lens

## Total Optical Excellence.

### BRILLIANT AISYS IMAGING

Canon AISYS (Aspectual Illumination System) features a compact optical array, capable of highly efficient light control. This works with LCOS technology to deliver a previously impossible combination: simultaneous high brightness and high contrast from a compact projector. With brightness levels of up to 4000 lumens and contrast ratios of up to 1000:1, every XEED delivers vivid images with striking colours and deep, pure blacks.

Inside the XEED Projector

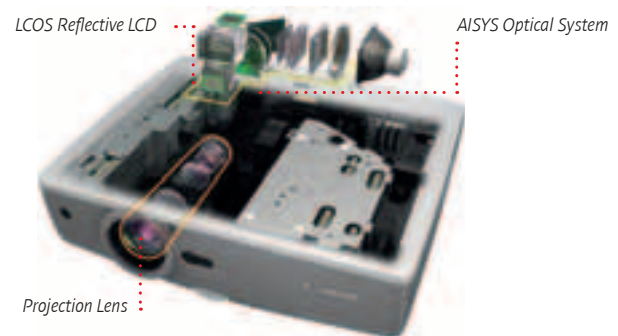

AISYS (Aspectual Illumination System)

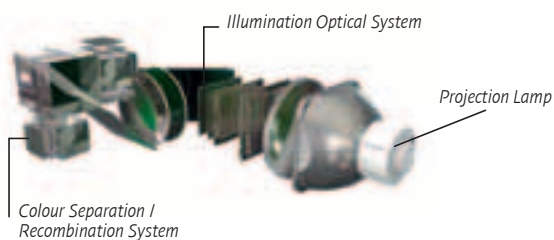

### GENUINE CANON OPTICS

Every XEED projector incorporates a wide-angle Canon projection lens with power-driven zoom. The XEED WUX10 Mark II, XEED SX80 Mark II and XEED SX800 all feature a 1.5x zoom lens, which virtually eliminates image distortion by using a special double-sided aspherical element.

Also included is 10:0 image offset, which matches the lower edge of the projected image to the optical axis of the lens – making installation straightforward, and reducing the need for Keystone Correction. Other XEED models offer an increased range of throw distances for a given image size, via a 1.7x powered zoom lens.



## Future Proof.

From television to computing, High Definition is changing the face of visual content. That's why most XEED projectors offer native SXGA+ resolution (1400 x 1050 pixels)\*. These models are HD Ready and give top quality results with HD sources – ensuring that you won't be left behind in the future.

*\*All models operate at SXGA+ resolution, except XEED X700 (XGA).*

### COMPARATIVE RESOLUTION CHART

Projector Resolution		Professional Image Quality	PC Compatibility						Video Compatibility	
			XGA 1024 x 768	WXGA 1280 x 800	SXGA 1280 x 1024	WXGA+ 1440 x 900	WSXGA+ 1680 x 1050	WUXGA 1920 x 1200	HD Ready (720p)	Full HD (1080p)
XGA	1024 x 768	x	✓	x	x	x	x	x	x	x
720p	1280 x 720	x	x	x	x	x	x	x	✓	x
WXGA	1280 x 768	x	✓	✓	x	x	x	x	✓	x
SXGA+	1400 x 1050	✓	✓	✓	✓	✓	x	x	✓	x
1080p	1920 x 1080	✓ ✓	✓	✓	✓	✓	✓	x	✓	✓
WUXGA	1920 x 1200	✓ ✓	✓	✓	✓	✓	✓	✓	✓	✓

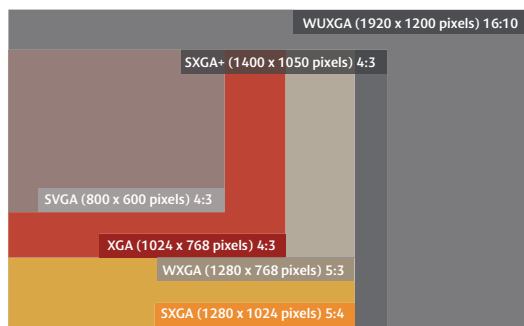

### HIGH RESOLUTION, HIGH QUALITY

Because quality presentations call for quality detail, XEED reproduces high resolution content with extra precision. Fine lines are rendered with pin-sharp accuracy, text remains legible at smaller font sizes, and multiple windows can be displayed without loss of image clarity.

### RESOLUTIONS COMPARED

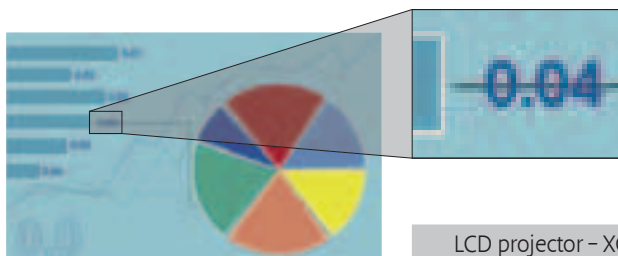

LCD projector – XGA resolution

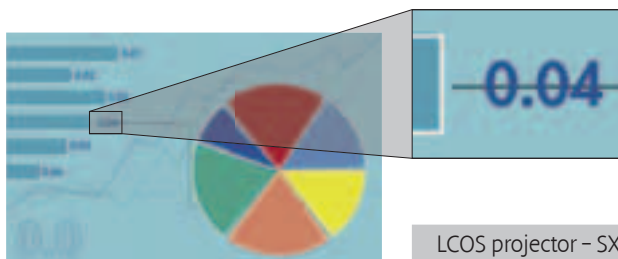

LCOS projector – SXGA+ resolution

### COMPATIBLE WITH MORE

Whatever the source, the XEED high resolution range of projectors ensures exceptional image quality.

PC – As native resolution on computer monitors continues to expand – with many new desktops and laptops offering SXGA+ resolution or above – the XEED range ensures that the audience sees exactly what's on your screen.

VIDEO – Display High Definition video as it should be seen. SXGA+ resolution allows most XEED models to reproduce 720p images without compression. And for stunning Full HD (1080p) image display, the XEED WUX10 Mark II features native WUXGA resolution (1920 x 1200 pixels).



# Get Connected.

Connect instantly to all standard image sources, via a comprehensive range of analogue and digital connectivity options – plus dedicated audio and control ports. Selected XEED models expand your presentation options with network connectivity, digital links to High Definition sources, and direct connections to USB flash drives or PictBridge-enabled digital cameras.

## NETWORK READY

For easy, centralised control and monitoring, the XEED WUX10 Mark II and XEED SX80 Mark II both feature a built-in RJ-45 port. An optional Network Adaptor is available as an accessory for most other XEED models.

## NETWORK CONNECTIVITY

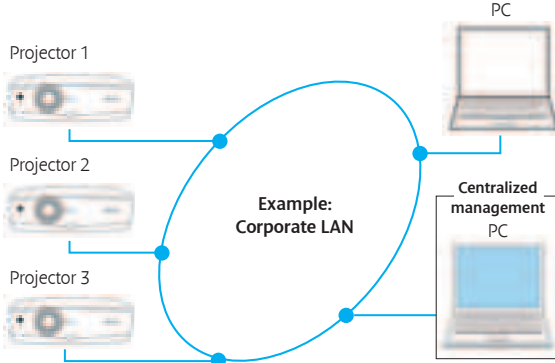

## LOSSLESS DETAIL

Both the XEED SX80 Mark II and XEED WUX10 Mark II include DVI and HDMI™ terminals, giving exacting image reproduction from High Definition sources like personal computers and set-top boxes.



## INTEGRATION OPTIONS

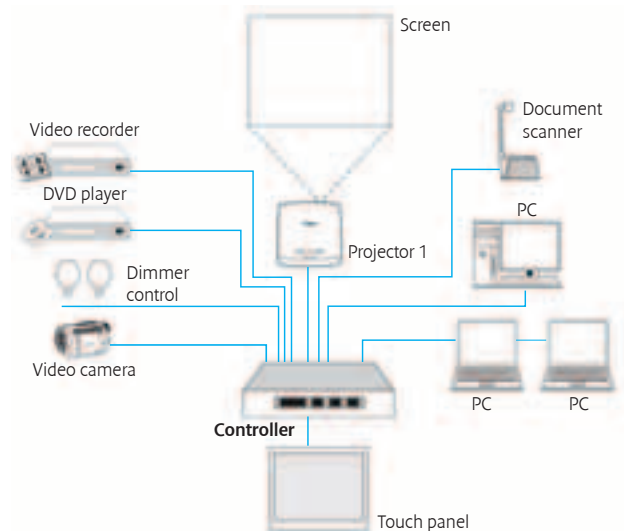

## NO PC REQUIRED

With the new “PC-Free Presentation” feature found on the XEED SX80 Mark II, you can project images straight from USB flash drives or PictBridge-enabled digital cameras - perfect for spontaneous presentations, or for occasions when carrying a computer is impractical.

## Dedicated Photo Mode.

For optimum display of photographic images, the WUX10 Mark II and SX80 Mark II feature a new PHOTO image mode. This mode adjusts the image to compensate for the brightness and tone of the ambient light, reproducing colours as they would appear on an sRGB monitor.

## Automatic Intelligence.

**Auto Focus\*** automatically sets the projector focus to the optimum position, taking into account throw distance and projection angle.

**Auto Vertical Keystone Correction** compensates for projector tilt up to +/- 20 degrees, to deliver perfectly square images with parallel edges.

**Auto Screen Colour Correction\*** compensates for the colour of the projection surface, to deliver perfect images with natural-looking colours.

\*Not available on XEED SX800.



## TARGET MARKETS

**Business & Education:** Boardrooms; Lecture Theatres, Conference Centres

**Specialist Applications:** Publishing, Printing & Pro Photo Applications; CAD & CAE; Simulation & Virtual Reality; Photographic exhibitions; Sports & Media Bars

## WUXGA and Full HD – the Best of Both Worlds.

With industry-leading WUXGA resolution (1920 x 1200 pixels), Full HD support and a new 'Photo' mode for colour-accurate images, the WUX10 Mark II is ideal for business and specialist AV use.

- Native WUXGA resolution (1920 x 1200 pixels) and Full HD capability (1080p)
- Canon LCOS panel technology for perfect, seamless images
- 3200 lumens brightness using Canon AISYS optical system
- 1000:1 contrast ratio for vivid colours and deep blacks
- Canon 1.5x powered zoom lens with 10:0 offset
- 'PHOTO' image mode for colour-accurate still images in any lighting environment
- Fully automatic setup configures Focus, Keystone Correction, Input Selection and Screen Colour Correction
- Near-silent operation: just 32dBA in Quiet Mode
- DVI port and HDMI™ Connector for digital image input
- RJ-45 network port for control and monitoring via a network

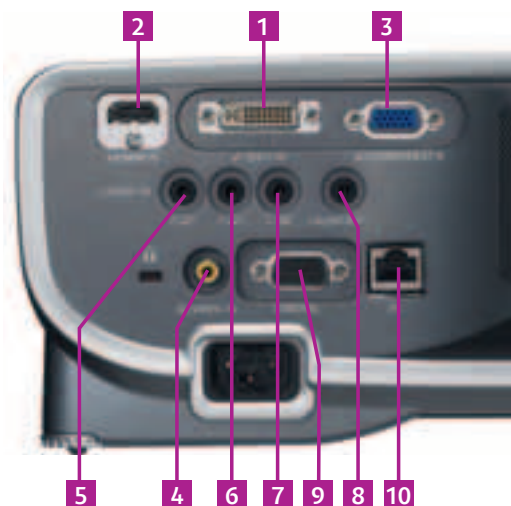

### VIDEO INPUT AND OUTPUT

- 1. DVI-I 29-pin**  
Digital RGB / Digital Video / Analogue RGB Input
- 2. HDMI™ v. 1.3 (with Deep Colour)**  
Digital Video and Digital Audio Input
- 3. Mini D-sub 15-pin**  
Analogue RGB Input 2 / Analogue RGB (Monitor) Output (Component input via optional adaptor cable)
- 4. RCA x 1**  
Composite Video Input

### AUDIO INPUT AND OUTPUT

- 5. 3.5mm mini-jack**  
Stereo Audio Input 1
- 6. 3.5mm mini-jack**  
Stereo Audio Input 2
- 7. 3.5mm mini-jack**  
Stereo Audio Input 3
- 8. 3.5mm mini-jack**  
Stereo Audio Output (Variable level)

### PROJECTOR CONTROL

- 9. Mini D-Sub 9-pin**  
Control Port (RS-232C)
- 10. RJ-45**  
Network Connection

### IN BOX ACCESSORIES

- Remote Controller
- AAA Batteries
- AC Mains Power Cable
- Computer Connection Cable
- Component Video Adaptor Cable
- Lens Cap
- Carrying Case
- Warranty Card
- Instruction Book
- Quick Operation Guide

### OPTIONAL ACCESSORIES

- Lamp Assembly RS-LP04
- DVI Cable (2 metres) LV-CA29
- Ceiling Mounting Bracket: RS-CL07
- Ceiling Pipe 400-600mm: RS-CL08
- Ceiling Pipe 600-1000mm: RS-CL09

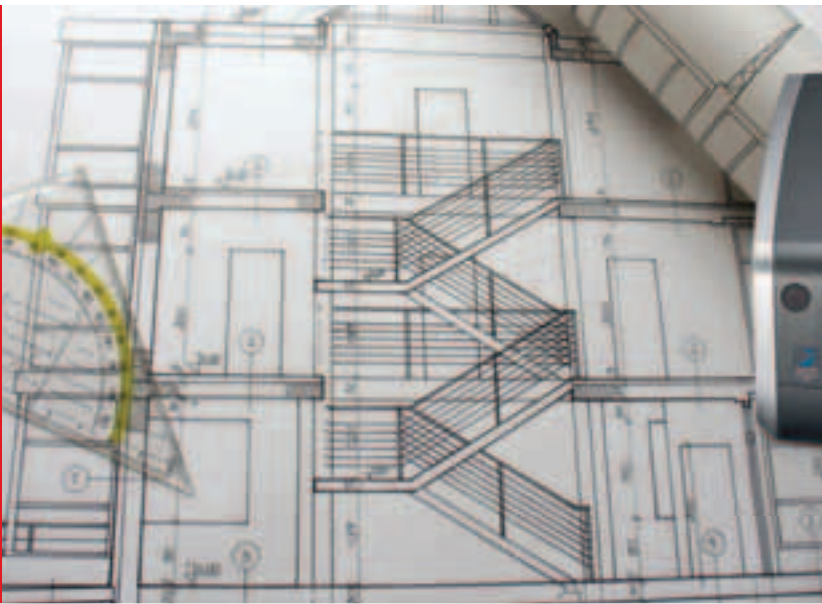

## TARGET MARKETS

**Business & Education:** Boardrooms; Lecture Theatres; Conference Centres

**Specialist Applications:** Photo Enthusiasts; Publishing, Printing & Pro Photo Applications; Museums; CAD & CAE; Simulation

## Superior Brightness. Perfect Detail.

The XEED SX7 is ideal for boardrooms, large venues and AV installations. Delivering an ultra-bright 4000 lumens projection at SXGA+ resolution, the XEED SX7 incorporates Canon's unique AISYS optical system for high brightness.

- Native SXGA+ resolution and LCOS technology for seamless, lattice-free images
- Canon Advanced AISYS Optical System delivers an ultra-bright 4000 lumens and 1000:1 contrast, for clear projection and vivid colours
- Fully automatic setup: Auto Focus, Auto Keystone Correction, Auto Screen Colour Correction and Auto Input Selection
- Canon powered wide-angle 1.7x zoom lens for flexible projector placement
- HD Ready, with HDCP-enabled DVI port
- Support for Adobe RGB and sRGB colour spaces, with bright sRGB mode
- Quiet operation: runs at just 31 dBA in Quiet Mode, to minimise audience distraction
- Compact, lightweight design – weighs just 4.8kg

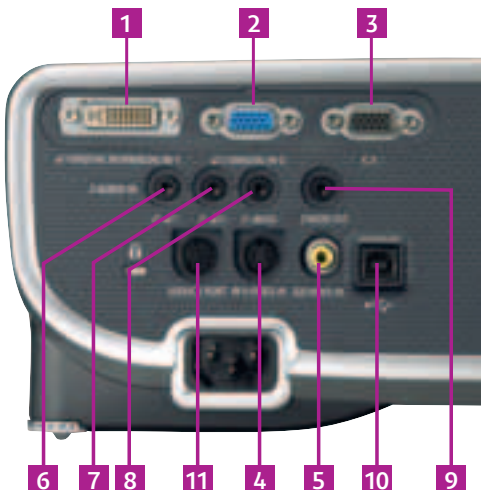

### VIDEO INPUT AND OUTPUT

- 1. DVI-I 29-pin**  
Digital RGB / Digital Video / Analogue RGB Input 1
- 2. Mini D-sub 15-pin**  
Analogue RGB Input 2 (Component/SCART via adaptor cable)
- 3. Mini D-sub 15-pin**  
Analogue RGB (Monitor) Output
- 4. Mini DIN 4-pin**  
S-Video Input
- 5. RCA x 1**  
Composite Video Input

### AUDIO INPUT AND OUTPUT

- 6. 3.5mm mini-jack**  
Stereo Audio Input 1
- 7. 3.5mm mini-jack**  
Stereo Audio Input 2
- 8. 3.5mm mini-jack**  
Stereo Audio Input 3
- 9. 3.5mm mini-jack**  
Stereo Audio Output (Variable level)

### PROJECTOR CONTROL

- 10. USB Type 'B'**  
USB Mouse Control
- 11. Mini-DIN 8-pin**  
Service Port

### IN BOX ACCESSORIES

- Remote Control (with batteries)
- Soft Case
- DVI-I Computer Connection Cable
- Component Video Cable
- AC Mains Power Cable
- USB Cable
- Lens Cap

### OPTIONAL ACCESSORIES

- Replacement Lamp: RS-LP04
- Ceiling Mounting Bracket: RS-CL07
- Ceiling Pipe 400-600mm: RS-CL08
- Ceiling Pipe 600-1000mm: RS-CL09
- SCART cable: LV-CA31
- RS-232C control cable: RS-CA01
- Network Adaptor: RS-NA01



**XEED SX6**



## TARGET MARKETS

### Business & Education:

Boardrooms; Lecture Theatres

**Specialist Applications:** Publishing, Printing & Pro Photo Applications; CAD & CAE; Medical

## Superior Projection for Enhanced Presentations.

Packed with powerful technology, the XEED SX6 is the ideal projector for maximum impact, high quality presentations. LCOS technology combines with SXGA+ resolution and Canon's unique AISYS optical system to provide detailed, seamless projection. The XEED SX6 offers advanced colour reproduction for graphics specialists.

- Native SXGA+ resolution and LCOS technology for seamless, lattice-free images
- Canon's Advanced AISYS Optical System delivers a bright 3500 lumens and 1000:1 contrast ratio, for clear projection and vivid colours
- Fully automatic setup: Auto Focus, Auto Keystone Correction, Auto Screen Colour Correction and Auto Input Selection
- Canon powered wide-angle 1.7x zoom lens for flexible projector placement
- HD Ready, with HDCP-enabled DVI port
- Support for Adobe RGB and sRGB colour spaces
- Quiet operation: runs at just 31 dBA in Quiet Mode, to minimise audience distraction

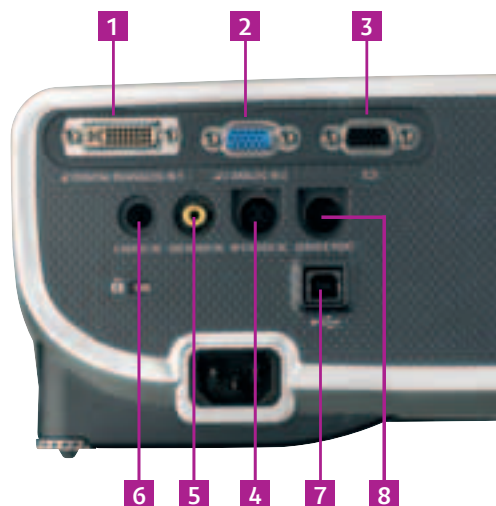

### VIDEO INPUT AND OUTPUT

- 1. DVI-I 29-pin**  
Digital RGB / Digital Video / Analogue RGB Input 1
- 2. Mini D-sub 15-pin**  
Analogue RGB Input 2 (Component SCART via adaptor cable)
- 3. Mini D-sub 15-pin**  
Analogue RGB (Monitor) Output
- 4. Mini DIN 4-pin**  
S-Video Input
- 5. RCA x 1**  
Composite Video Input

### AUDIO INPUT AND OUTPUT

- 6. 3.5mm mini-jack**  
Stereo Audio Input

### PROJECTOR CONTROL

- 7. USB Type 'B'**  
USB Mouse Control
- 8. Mini-DIN 8-pin**  
Service Port

### IN BOX ACCESSORIES

Remote Control (with batteries)  
Soft Case  
DVI-I Computer Connection Cable  
Component Video Cable  
AC Mains Power Cable  
USB Cable  
Lens Cap

### OPTIONAL ACCESSORIES

Replacement Lamp: RS-LP02  
Ceiling Mounting Bracket: RS-CL07  
Ceiling Pipe 400-600mm: RS-CL08  
Ceiling Pipe 600-1000mm: RS-CL09  
SCART cable: LV-CA31  
RS-232C control cable: RS-CA34  
Network Adaptor: RS-NA01





## TARGET MARKETS

**Business & Education:** Boardrooms; Lecture Theatres; Conference Centres

**Specialist Applications:** Professional Photography, Simulation, Design, Publishing

## Unrivalled Clarity. Complete Connectivity.

The SX80 Mark II produces crystal-clear SXGA+ images from most sources, including HDMI, DVI and USB flash drives. A dedicated 'Photo' mode ensures superb colour accuracy in any lighting environment.

- Native SXGA+ resolution (1400 x 1050 pixels) with Canon LCOS technology
- 3000 lumens brightness using Canon AISYS Optical System
- 900:1 contrast ratio for vivid colours and deep blacks
- Canon 1.5x powered zoom lens with 10:0 offset
- 'PHOTO' image mode for colour-accurate still images in any lighting environment
- Fully automatic setup configures Focus, Keystone Correction, Input Selection and Screen Colour Correction
- PC-Less presentation: Display images directly from USB flash drives and digital cameras
- Near-silent operation: just 31 dBA in Quiet Mode
- DVI port and HDMI™ Connector for digital image input
- RJ-45 port for control and monitoring via a network

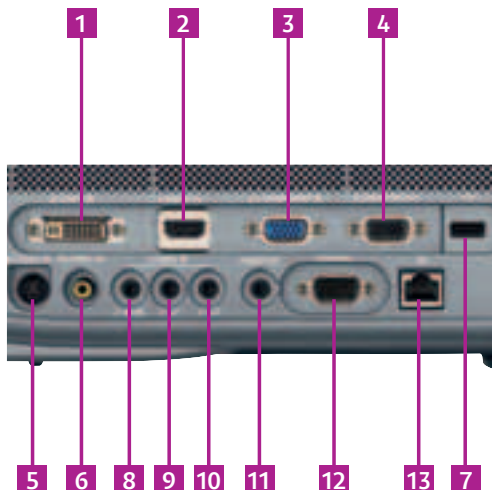

### VIDEO INPUT AND OUTPUT

- 1. DVI-I 29-pin**  
Digital RGB / Digital Video / Analogue RGB Input
- 2. HDMI™ v. 1.3 (with Deep Colour)**  
Digital Video and Digital Audio Input
- 3. Mini D-sub 15-pin**  
Analogue RGB Input 2 (Component input via optional adaptor cable)
- 4. Mini D-sub 15-pin**  
Analogue RGB (monitor) output
- 5. Min-DIN 4 Pin**  
S video input
- 6. RCA x 1**  
Composite Video Input
- 7. USB Type A**  
USB Connection, PictBridge input

### AUDIO INPUT AND OUTPUT

- 8. 3.5mm mini-jack**  
Stereo Audio Input 1
- 9. 3.5mm mini-jack**  
Stereo Audio Input 2
- 10. 3.5mm mini-jack**  
Stereo Audio Input 3
- 11. 3.5mm mini-jack**  
Stereo Audio Output (Variable level)

### PROJECTOR CONTROL

- 12. Mini D-Sub 9-pin**  
Control Port (RS-232C)
- 13. RJ-45**  
Network connection

### IN BOX ACCESSORIES

Remote Controller  
AAA Batteries  
AC Mains Power Cable  
Computer Connection Cable  
Component Video Adaptor Cable  
Lens Cap  
Carrying Case  
Warranty Card  
Instruction Book  
Quick Operation Guide

### OPTIONAL ACCESSORIES

Lamp Assembly RS-LP05  
DVI Cable (2 metres) LV-CA29  
Ceiling Mounting Bracket: RS-CL10  
Ceiling Pipe 400-600mm: RS-CL08  
Ceiling Pipe 600-1000mm: RS-CL09



## TARGET MARKETS

### Business & Education:

Hotels - Conference Facilities, General Business Use, (Meetings, Presentations), Higher Education, Medical Imaging

## The affordable way to SXGA+ quality.

With Canon LCOS technology and a bright 3000 lumens output, the XEED SX800 offers top-quality SXGA+ imaging at a price point more often associated with XGA models. The addition of Canon's 1.5x zoom lens ensures flexible placement and perfect image geometry.

- Native SXGA+ resolution with Canon LCOS panel technology for outstanding image quality
- Canon AISYS Optical System delivers 3000 lumens brightness
- 900:1 contrast ratio for vivid colours and deep blacks
- Canon 1.5x powered zoom lens with 10:0 lens shift for easy installation
- Automatic Setup: Auto Keystone Correction and Auto Input Selection
- Near-silent operation: just 31 dBA in Quiet Mode
- Body and ceiling bracket designed for easy installation and maintenance

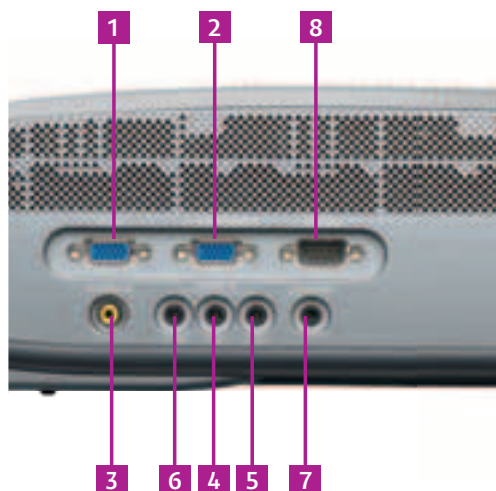

### VIDEO INPUT AND OUTPUT

1. Mini D-sub 15-pin Analogue RGB Input 1 (Component via optional adaptor cable)
2. Mini D-sub 15-pin Analogue RGB Input 2
3. RCA x 1 Composite Video Input

### AUDIO INPUT AND OUTPUT

4. 3.5mm mini-jack Stereo Audio Input 1
5. 3.5mm mini-jack Stereo Audio Input 2
6. 3.5mm mini-jack Stereo Audio Input 3
7. 3.5mm mini-jack Stereo Audio Output (Variable level)

### PROJECTOR CONTROL

8. Mini D-Sub 9-pin Control Port (RS-232C)

### IN BOX ACCESSORIES

Remote Control (with batteries)  
AC Mains Power Cable  
Computer Connection Cable  
Component Video Adaptor Cable  
Carrying Case  
Warranty Card  
Instruction Book  
Quick Operation Guide

### OPTIONAL ACCESSORIES

Lamp Assembly RS-LP05  
Ceiling Attachment RS-CL10  
Ceiling Pipe 400 - 600mm RS-CL08  
Ceiling Pipe 600 - 1000mm RS-CL09



## TARGET MARKETS

**Business & Education:** School Halls; Lecture Theatres; Large Meeting Rooms

**Specialist Applications:** Exhibition Halls; Auditoriums; Large Venues; Public Signage; Sports and Media bars

## Startling Brightness. Seamless Clarity.

When brightness and image quality are essential, the XEED X700 provides 4000 lumens at XGA resolution. Smooth LCOS imaging, enhanced by Canon's unique AISYS technology, make the XEED X700 ideal for medium to large spaces, including spaces with high levels of ambient light.

- Native XGA resolution and LCOS technology for seamless images
- Canon Advanced AISYS Optical System delivers an ultra-bright 4000 lumens for clear projection, even in daylight and large venues
- 1000:1 contrast ratio for vivid colours and deeper blacks
- Fully automatic setup: Auto Focus, Auto Keystone Correction, Auto Screen Colour Correction and Auto Input Selection
- Canon powered wide-angle 1.7x zoom lens for flexible projector placement
- Just 31dBA operation in Quiet Mode
- HDCP-enabled DVI port for pin-sharp images from digital sources
- Support for sRGB colour space
- Optional Network Adaptor for control and monitoring

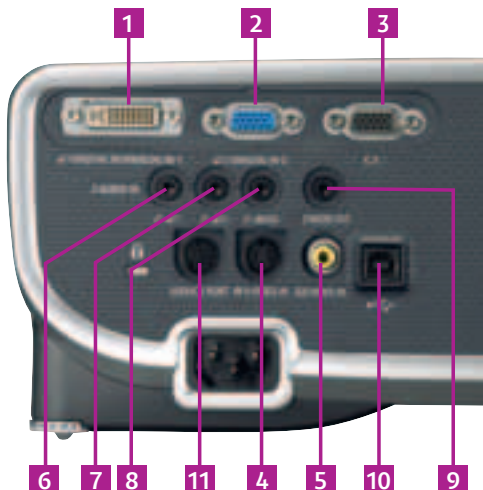

### VIDEO INPUT AND OUTPUT

- 1. DVI-I 29-pin**  
Digital RGB / Digital Video / Analogue RGB Input 1
- 2. Mini D-sub 15-pin**  
Analogue RGB Input 2 (Component/SCART via adaptor cable)
- 3. Mini D-sub 15-pin**  
Analogue RGB (Monitor) Output
- 4. Mini DIN 4-pin**  
S-Video Input
- 5. RCA x1**  
Composite Video Input

### AUDIO INPUT AND OUTPUT

- 6. 3.5mm mini-jack**  
Stereo Audio Input 1
- 7. 3.5mm mini-jack**  
Stereo Audio Input 2
- 8. 3.5mm mini-jack**  
Stereo Audio Input 3
- 9. 3.5mm mini-jack**  
Stereo Audio Output (Variable level)

### PROJECTOR CONTROL

- 10. USB Type 'B'**  
USB Mouse Control
- 11. Mini-DIN 8-pin**  
Service Port

### IN BOX ACCESSORIES

Remote Control (with batteries)  
Soft Case  
DVI-I Computer Connection Cable  
Component Video Cable  
AC Mains Power Cable  
USB Cable  
Lens Cap

### OPTIONAL ACCESSORIES

Replacement Lamp: RS-LP04  
Ceiling Mounting Bracket: RS-CL07  
Ceiling Pipe 400-600mm: RS-CL08  
Ceiling Pipe 600-1000mm: RS-CL09  
SCART cable: LV-CA31  
RS-232C control cable: RS-CA01  
Network Adaptor: RS-NA01

Specifications	XEED WUX10 Mark II	XEED SX7	XEED SX6	XEED SX80 Mark II	XEED SX800	XEED X700
Product Class	Ultra-Portable					
LCD PANEL						
Type	LCOS Reflective Display, TFT Active Matrix					
Size and Number	0.7" diagonal (15.4mm x 9.6mm), 3 panels	0.7" diagonal (15mm x 11mm), 3 panels		0.55" diagonal (11.2mm x 8.4mm), 3 panels		0.7" diagonal (15mm x 11mm), 3 panels
Aspect Ratio	16:10	4:3				
Native Resolution	1920 x 1200 (WUXGA), 2,304,000 pixels	1400 x 1050 (SXGA+), 1,470,000 pixels				1024 x 768 (XGA), 786,432 pixels
OPTICS						
Lamp Type	275W NSHA		270W NSH	230W NSHA		275W NSHA
Lens F Number and Focal Length	F1.85 - F2.65; f=21.8 - 31.9mm	F1.85 - F2.5; f=21.7 - 35.8mm		F1.95 - F2.6; f=16.6 - 24.8mm		F1.85 - F2.5; f=21.7 - 35.8mm
Zoom Magnification and Control	1.5x Motorised	1.7x Motorised		1.5x Motorised		1.7x Motorised
Focus Control	Motorised Auto Focus			Motorised Auto / Manual Focus	Motorised Manual Focus	Motorised Auto Focus
Lens Shift	10:0, fixed	9:1, fixed		10:0, fixed		9:1, fixed
IMAGE AND AUDIO						
Brightness	3200 lumens	4000 lumens	3500 lumens	3000 lumens		4000 lumens
Brightness Uniformity	88%					
Contrast Ratio	1000:1 (full on / full off)			900:1 (full on / full off)		1000:1 (full on / full off)
Projection Distance Coverage	1.2m - 9.1m (3.0 - 4.4m for 100" image)	1.2m - 9.0m (3.0m - 4.9m for 100" image)		1.2m - 9.1m (3.0 - 4.4m for 100" image)		1.2m - 9.0m (3.0m - 4.9m for 100" image)
Screen Size	40" - 300" (81 x 61cm - 610 x 457cm)					
Digital Zoom Magnification	1x - 12x					
Keystone Correction Range	Vertical: +/- 20° (Auto / Manual), Horizontal: None	Vertical: +/- 20° (Auto / Manual), Horizontal: +/- 20° (Manual)		Vertical: +/- 20° (Auto / Manual), Horizontal: None		Vertical: +/- 20° (Auto / Manual), Horizontal: +/- 20° (Manual)
Digital RGB Compatibility	WUXGA / UXGA / WSXGA+ / SXGA+ / WXGA+ / SXGA / XGA / SVGA / VGA	SXGA+ / SXGA / WXGA / XGA / SVGA / VGA			—	XGA / SVGA / VGA
Analogue RGB Compatibility	WUXGA / UXGA / SXGA+ / WXGA+ / SXGA / WXGA / XGA / SVGA / VGA	UXGA / SXGA+ / SXGA / WXGA / XGA / SVGA / VGA				
Component Video Scan Systems	1080p / 1080i / 1035i / 720p / 576p / 576i / 480p / 480i	1080i / 1035i / 720p / 575p / 575i / 480p / 480i		1080p / 1080i / 1035i / 720p / 576p / 576i / 480p / 480i		1080i / 1035i / 720p / 575p / 575i / 480p / 480i
Video / S-Video Colour Systems	PAL / PAL-M / PAL-N / NTSC / NTSC4.43 / SECAM					
Scanning Frequency	Horizontal: 15-75kHz, Vertical: 50-85Hz, Clock: 170 MHz	Horizontal: 15-100kHz, Vertical: 50-100Hz, Clock: 170MHz		Horizontal: 15-75kHz, Vertical: 50-85Hz, Clock: 170MHz		Horizontal: 15-100kHz, Vertical: 50-100Hz, Clock: 170MHz
Image Modes	Standard, Presentation, Movie, sRGB, Photo	Standard, Presentation, Movie & Photo, Adobe RGB, sRGB	Standard, Presentation, Movie & Photo, Adobe RGB, sRGB	Standard, Presentation, Movie, sRGB, Photo	Standard, Presentation, Movie, sRGB	
Image Enhancement	12-bit Digital Gamma Correction, 6-axis Colour Adjust				12-bit Digital Gamma Correction	12-bit Digital Gamma Correction, 6-axis Colour Adjust
Built-In Audio	1.0W RMS, Monaural					
CONNECTORS						
Digital RGB / Analogue RGB Input 1	DVI-I 29-pin (HDCP compatible)				Mini-D-Sub 15-pin (Analogue only)	DVI-I 29-pin (HDCP compatible)
Digital Video / Digital Audio Input	HDMI Version 1.3 (with Deep Colour)	—	—	HDMI Version 1.3 (with Deep Colour)	—	—
Analogue RGB Input 2	Mini D-Sub 15-pin					
Analogue RGB Output	Mini D-Sub 15-pin				—	Mini D-Sub 15-pin
Component Video Input	Via 3x RCA adaptor cable (supplied)					
S-Video Input	—	Mini-DIN 4-pin			—	Mini-DIN 4-pin
Composite Video Input	RCA x 1					
Audio Input 1	3.5mm stereo mini-jack					
Audio Input 2	3.5mm stereo mini-jack		—	3.5mm stereo mini-jack		
Audio Input 3	3.5mm stereo mini-jack		—	3.5mm stereo mini-jack		
Audio Output	3.5mm stereo mini-jack (variable level)		—	3.5mm stereo mini-jack (variable level)		
Mouse Control	—	USB Type B		USB Type A (PictBridge enabled)	—	USB Type B
Service Port / Projector Control	Mini D-Sub 9-pin	Mini-DIN 8-pin		Mini D-Sub 9-pin		Mini-DIN 8-pin
Network Port	RJ-45	Via optional network adaptor		RJ-45	—	Via optional network adaptor
MECHANISMS						
Front Elevation Mechanism	One-Touch mechanical foot, 10° maximum image elevation					
Rear Adjustment Mechanism	Two rotary feet for fine adjustment					
RATINGS						
Dimensions (W x H x D)	284 x 114 x 336mm	266 x 114 x 336mm		332 x 121 x 340mm		266 x 114 x 336mm
Weight	5.0kg	4.8kg	4.7kg	5.2kg	5.0kg	4.8kg
Rated Supply Voltage	100V - 240V AC, 50/60Hz					
Power Consumption	Normal Mode: 400W / Quiet Mode: 330W / Standby: 11W	Normal Mode: 360W / Quiet Mode: 290W / Standby: 7W	Normal Mode: 355W / Quiet Mode: 290W / Standby: 7W	Normal Mode: 330W / Quiet Mode: 270W / Standby: 15W	Normal Mode: 320W / Quiet Mode: 260W / Standby: 8W	Normal Mode: 360W / Quiet Mode: 290W / Standby: 7W
Noise Level	Normal Mode: 36dBA / Quiet Mode: 32dBA			Normal Mode: 35dBA / Quiet Mode: 31dBA	Normal Mode: 36dBA / Quiet Mode: 32dBA	
Operating Environment	+5°C to +35°C					
Storage Environment	-30°C to +60°C					
Warranty	3 years					

Some images are simulated for clarity of reproduction. All data is based on Canon's standard testing methods. Specifications are subject to change without notice.

™ and ©: All company and/or product names are trademarks and/or registered trademarks of their respective manufacturers in their markets and/or countries.



**Canon Inc.**  
www.canon.com

**Canon Europa N.V.**  
www.canon-europe.com

English Edition 0113W057  
© Canon Europa N.V., 2009 (0909)

**Canon Europe Ltd**  
3 The Square  
Stockley Park  
Uxbridge  
Middlesex  
UB11 1ET  
United Kingdom